

Mounting Instructions

1. Choose whether you would like to mount the panel horizontally or vertically.
2. Select which position (A, B, C or D) you would like the cable box to be in using the enclosed mounting template.

Note: Positions A and C are for horizontal mounting, and positions B and D are for vertical mounting.

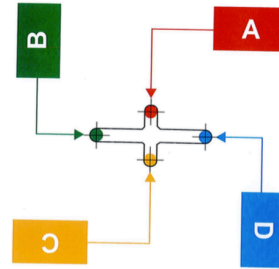

3. Peel the adhesive tabs from the back of the mounting template and place it on the wall or ceiling on which you want to mount the panel. If you do not have a mounting template, please reference the dimensions below.

600mm x 1200mm

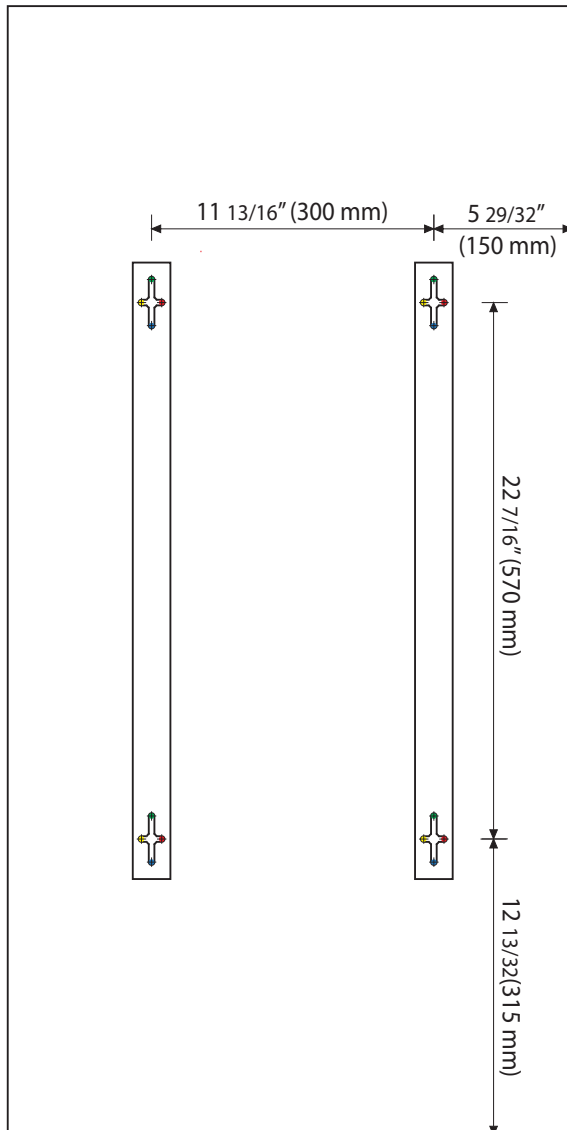

600mm x 900mm

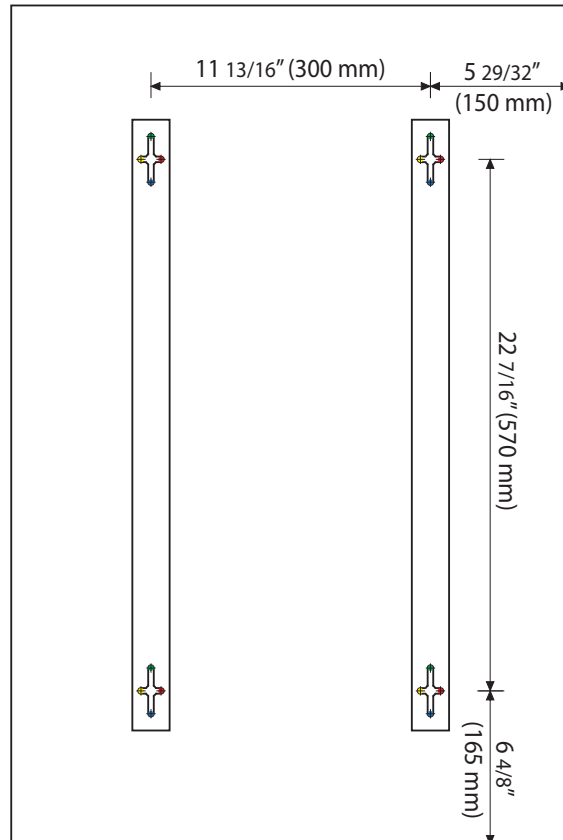

Mounting Instructions

4. Mark four holes for drilling, as selected in Step 2.

Note: There should only be one hole per cross. Be sure to select the same color/letter for each cross.

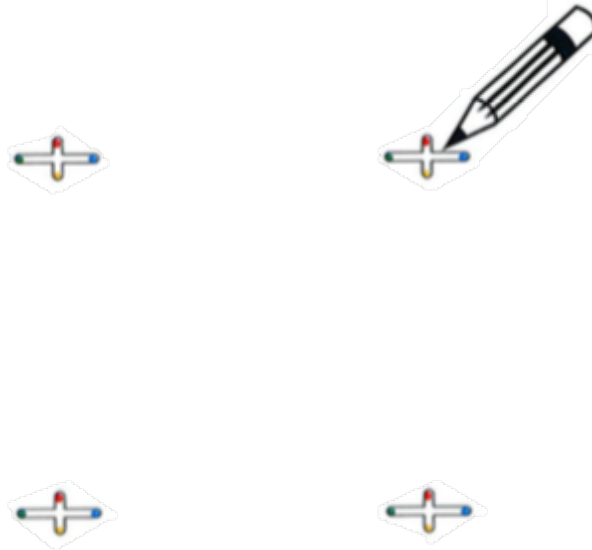

5. Drill the holes using a drill bit size that is slightly smaller than the drywall anchor. Then insert the drywall anchors into the holes, and screw the screws into the drywall anchors.

Note: Leave 19/32 in. (15 mm) of the screw protruding from the anchor.

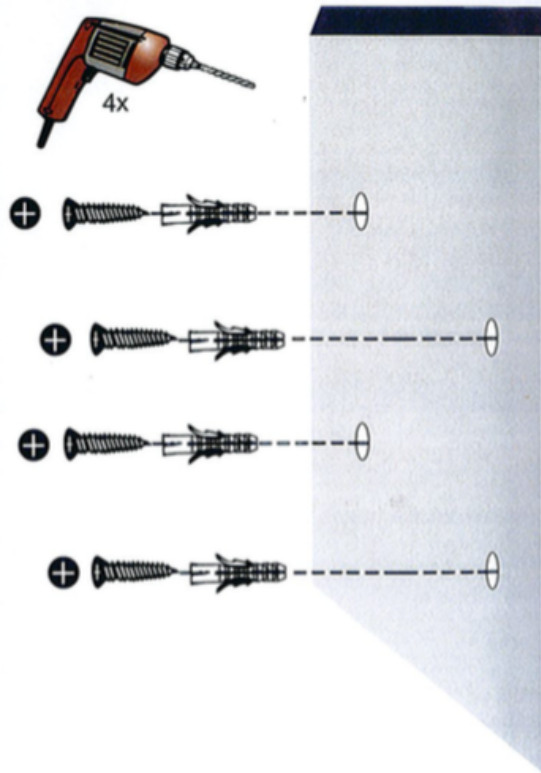

Mounting Instructions

6. Carefully hang the panel on the provided screws.

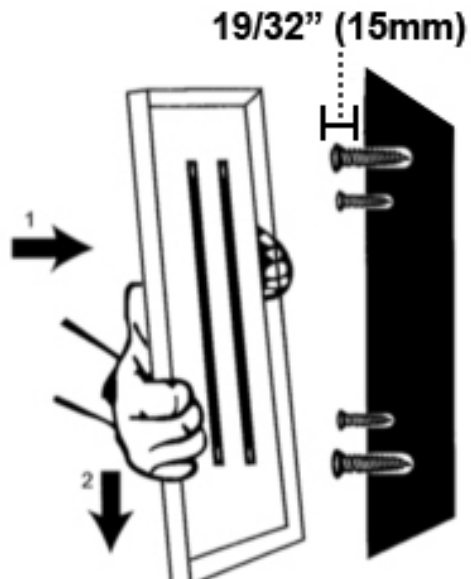

7. Plug the unit into a standard outlet to operate.

